

### Blade Guard Attachment

An inexpensive way to minimize the risk of operator injury, this blade guard attaches easily to any Performance Series, C Series, or other knifeholders while maintaining existing minimum slit widths.

659075, Class I  
659076, Class II  
659077, Class III

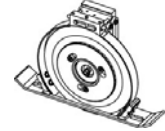

### Bench Fixture

Mount the Tidland bench fixture at any angle to make safe and easy off-machine blade changes and adjustments.

130796, Class I  
130788, Class II  
130822, Class III  
n/a, e-Knifeholder

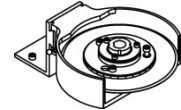

### Easy Glider Mount Assembly

A cost-effective, easy-to-install solution for faster knifeholder positioning on manual or semi-automatic slitters that are currently equipped with Tidland Performance Series Knifeholders. (Requires Easy Glider guide bar.)

662077, Class I  
615576, Class II  
618966, Class III

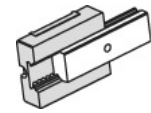

### Stainless Steel Protective Glove

Woven metal fibers provide protection from slicing-type hazards.

132084



### Coalescing Filter/Air Regulator Kit

The Coalescing Filter/Air Regulator fits between plant air supply and the knifeholder air manifold (single or dual manifold).

520984, single  
520985, dual

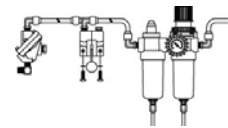

### Blade Cartridges with Knife Blades for Shear Slitting – Performance Series

Change blades in seconds with complete replacement assemblies.

Manual Cartridge Assembly

Automatic Cartridge Assembly

Class I	Class II	Class III	e-Knifeholder
551430	131061	132872	n/a
547613	524508	535264	CLII 696317 CLIII 700518

### Knife Blades

90mm OD x 60mm ID, D-2	131937	N/A	N/A
90mm OD x 60mm ID x 6mm, D-2	131972	N/A	N/A
150mm OD x 80mm ID, 52-100 (25°)	N/A	128216	N/A
150mm OD x 80mm ID, D-2 (25°)	N/A	128401	N/A
150mm OD x 80mm ID, D-2 super finish (45°)	N/A	133399	N/A
150mm OD x 80mm ID x 10mm, D-2 (5°)	N/A	131973	N/A
200mm OD x 80mm ID, 52-100 (25°)	N/A	N/A	129832
200mm OD x 80mm ID, D-2 (25°)	N/A	N/A	129833
200mm OD x 80mm ID, D-2 super finish (45°)	N/A	N/A	133389
200mm OD x 80mm ID, Powdered Metal	N/A	N/A	501835

### Technical Documentation

Installation, Operation and Maintenance manuals for Tidland Performance Series Knifeholders

Performance Series Manual Knifeholder	557416	e-Knifeholder	686610
Performance Series Automatic Knifeholder	557417	Precision Lock Knifeholder	553334
Performance Series Crush Knifeholder	612075		

# Blade Grinding and Finishing

- Correct blade sharpness is essential for shear and crush slitting operations.
- To reduce chipping and rapid dulling of blades, it is important to remove burred edges.
- Grind the blade edge as smooth as possible to avoid dust formation during the slitting process.
- **Before putting blade into operation**, install the blade and set up the knifeholder at the anvil ring. Manually rotate the blade against the anvil in the reverse direction for a few revolutions. This will help deburr the blade after grinding and provide a smooth slitting edge.

Suggested Blade Grinding Procedure			
Step	Procedure	Wet/Dry	Grit/Hardware
1	If required, grind to remove chips, restore roundness, etc.	Wet	46/60 med/soft
2	Rough grind blade edge	Wet	100 medium
3	Finish grind blade edge	Wet	180 med/hard
4	Deburr	Dry (hand)	Oilstone

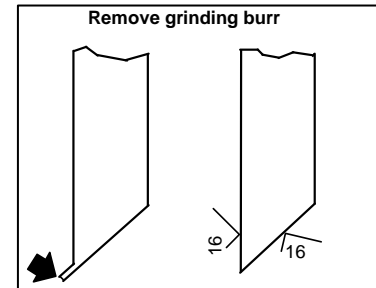

## Knife Blades – Shear

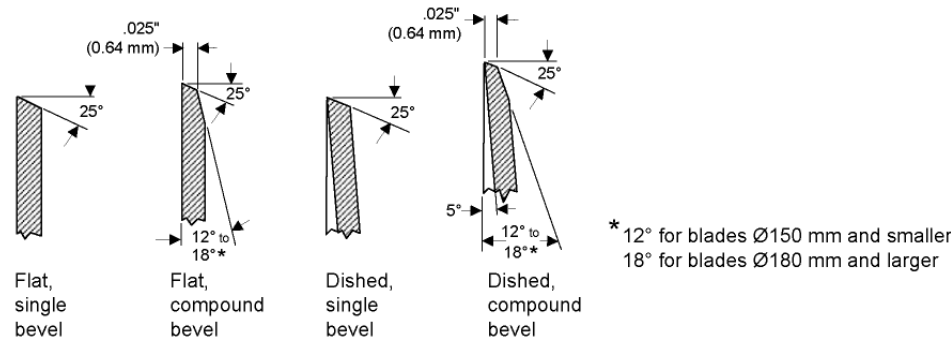

## Anvil Rings – Shear

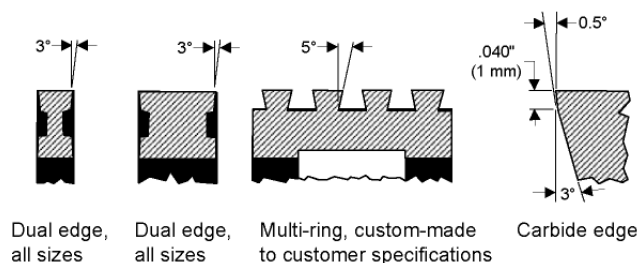

All rights reserved. No part of this publication may be reproduced, transmitted, transcribed, stored in a retrieval system, or translated into any language in any form by any means without the written permission of Tidland Corporation.



**Tidland Corporation**  
 2305 SE 8<sup>th</sup> Avenue  
 Camas, WA 98607 USA  
 Phone: 1-800-426-1000  
 1-360-834-2345  
 Fax: 1-360-834-5865  
 E-mail: [tidland@tidland.com](mailto:tidland@tidland.com)  
 Web: [www.tidland.com](http://www.tidland.com)

**Maxcess Europe**  
 Fifestrasse 1, D-65779  
 Kelkheim/Ts., Germany  
 Phone: (49) 6195-7002-433  
 Fax: (49) 6195-7002-933  
 E-mail: [info@maxcess.eu](mailto:info@maxcess.eu)

**Maxcess Asia**  
 300 Orchard Road No. 15-05  
 Orchard Towers  
 Singapore 238875  
 Phone: (65) 9620-3883  
 Fax: (65) 6235-4818  
 E-mail: [asia@maxcessintl.com](mailto:asia@maxcessintl.com)